

## Level Measurement

Continuous level measurement  
Ultrasonic transmitters

### The Probe

#### Overview



The Probe is a short-range integrated ultrasonic level transmitter, ideal for liquids and slurries in open or closed vessels.

#### Benefits

- Easy to install, program, and maintain
- Accurate and reliable
- Sanitary models available
- Sonic Intelligence echo processing
- Integral temperature compensation

#### Application

The transducer is available in PVDF copolymer, making the device suitable for use in a wide variety of applications. The Probe is easy to install and maintain, and can be quickly removed for cleaning as required by the food, beverage and pharmaceutical industries.

The reliability of the level data is based on the Sonic Intelligence echo processing algorithms. A filter discriminates between the true echo and false echoes from acoustic or electrical noises and agitator blades in motion. The ultrasonic pulse propagation time to the material and back is temperature-compensated and converted into distance for display, analog output and relay actuation.

- Key Applications: chemical storage vessels, filter beds, mud pits, liquid storage vessels, food applications

#### Configuration

##### Parabolic mounting

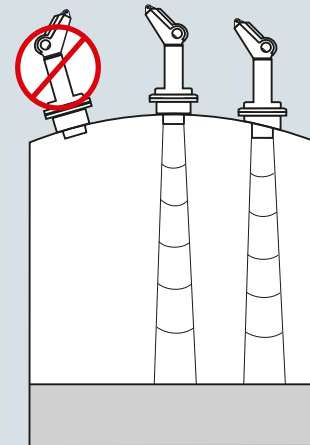

##### Flat mounting and beam angle

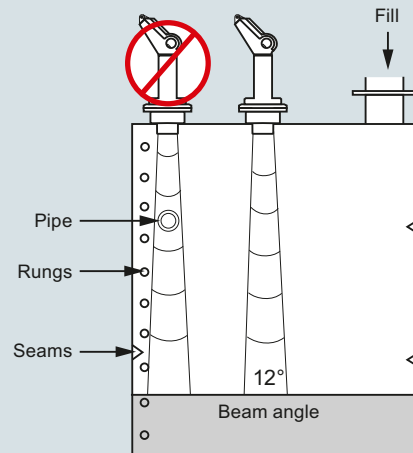

The Probe mounting



# Level Measurement

Continuous level measurement  
Ultrasonic transmitters

## The Probe

### Options

Flange adapter for mating 2" NPT or 2" BSP process connections to 3" ANSI, DN 65 PN10, and JIS 10K 3B flanges

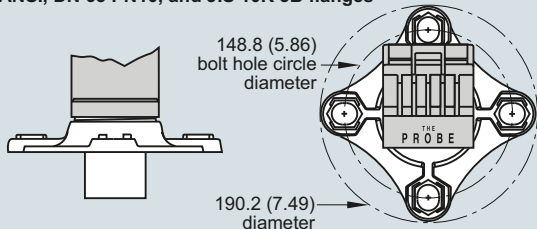

The Probe optional flange adapter, dimensions in mm (inch)

The Probe with FMS 200 mounting bracket

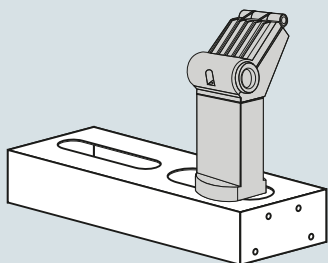

The Probe with optional mounting bracket

### Circuit diagrams

3 wire model  
(standard and sanitary models)

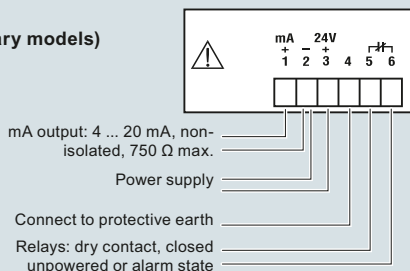

Display

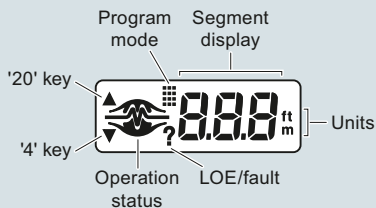

The Probe connections

### Dimensional drawings

Standard model

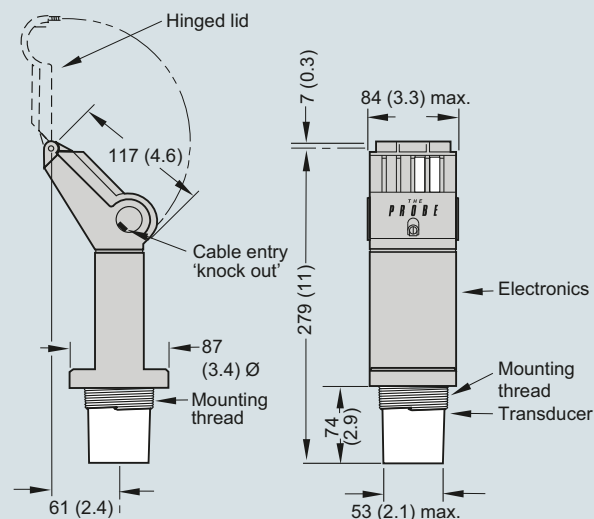

Sanitary model

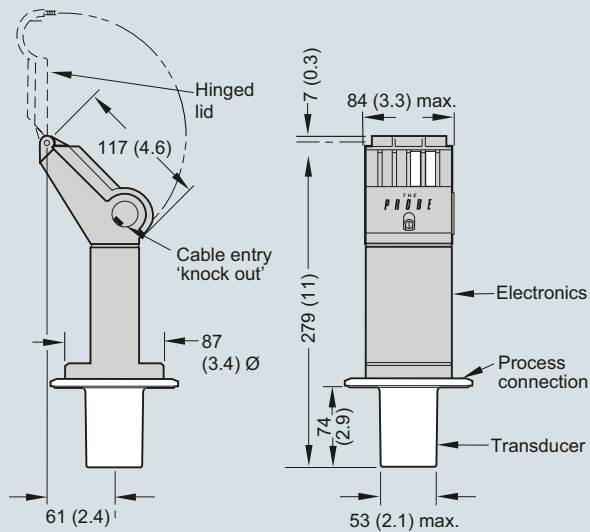

The Probe, dimensions in mm (inch)

4